

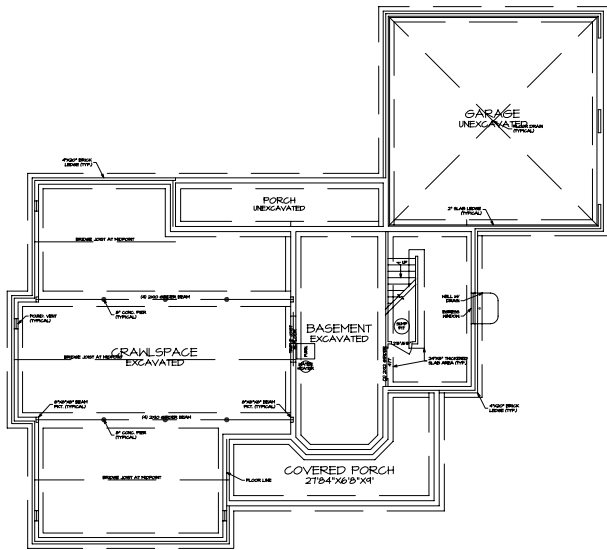

1 FRONT ELEVATION  
A-1 SCALE: 1/4"=1'-0"



1 FOUNDATION PLAN  
A-3 SCALE: 1/4"=1'-0"

FOUNDATION PLAN NOTES:  
1. ALL FOUNDATION WALLS SHALL BE CONCRETE ON GRADE.  
2. ALL FOUNDATION WALLS SHALL BE 12" THICK UNLESS NOTED OTHERWISE.  
3. ALL FOUNDATION WALLS SHALL BE FINISHED WITH 1/2" GYPSUM BOARD TO INTERIOR SURFACE.  
4. ALL FOUNDATION WALLS SHALL BE FINISHED WITH 1/2" GYPSUM BOARD TO EXTERIOR SURFACE.  
5. ALL FOUNDATION WALLS SHALL BE FINISHED WITH 1/2" GYPSUM BOARD TO INTERIOR SURFACE.  
6. ALL FOUNDATION WALLS SHALL BE FINISHED WITH 1/2" GYPSUM BOARD TO EXTERIOR SURFACE.  
7. ALL FOUNDATION WALLS SHALL BE FINISHED WITH 1/2" GYPSUM BOARD TO INTERIOR SURFACE.  
8. ALL FOUNDATION WALLS SHALL BE FINISHED WITH 1/2" GYPSUM BOARD TO EXTERIOR SURFACE.

STATISTICS:		
AREA:	EXISTING:	PROPOSED:
FIRST FLOOR AREA:	N/A	2,070 S.F.
SECOND FLOOR AREA:	N/A	469 S.F.
TOTAL LIVING AREA:	N/A	2,539 S.F.
BASEMENT AREA:	N/A	625 S.F.
GARAGE AREA:	N/A	822 S.F.
TOTAL AREA:	N/A	3,986 S.F.

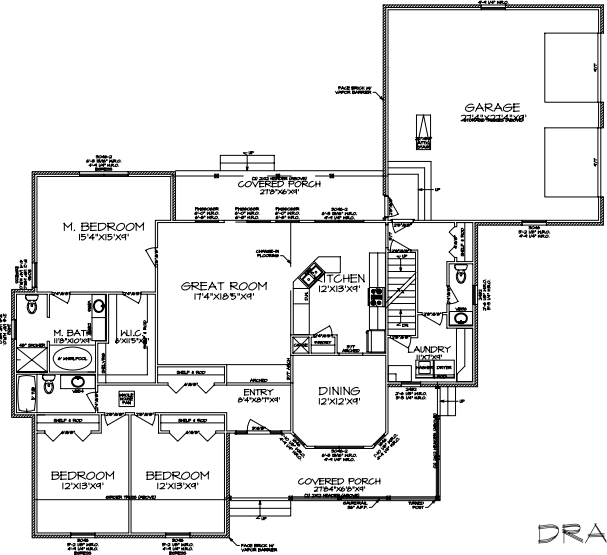

1 FIRST FLOOR PLAN  
A-1 SCALE: 1/4"=1'-0"

FIRST FLOOR PLAN NOTES:  
1. ALL INTERIOR WALLS SHALL BE 1/2" GYPSUM BOARD TO INTERIOR SURFACE.  
2. ALL INTERIOR WALLS SHALL BE FINISHED WITH 1/2" GYPSUM BOARD TO INTERIOR SURFACE.  
3. ALL INTERIOR WALLS SHALL BE FINISHED WITH 1/2" GYPSUM BOARD TO INTERIOR SURFACE.  
4. ALL INTERIOR WALLS SHALL BE FINISHED WITH 1/2" GYPSUM BOARD TO INTERIOR SURFACE.  
5. ALL INTERIOR WALLS SHALL BE FINISHED WITH 1/2" GYPSUM BOARD TO INTERIOR SURFACE.  
6. ALL INTERIOR WALLS SHALL BE FINISHED WITH 1/2" GYPSUM BOARD TO INTERIOR SURFACE.  
7. ALL INTERIOR WALLS SHALL BE FINISHED WITH 1/2" GYPSUM BOARD TO INTERIOR SURFACE.  
8. ALL INTERIOR WALLS SHALL BE FINISHED WITH 1/2" GYPSUM BOARD TO INTERIOR SURFACE.

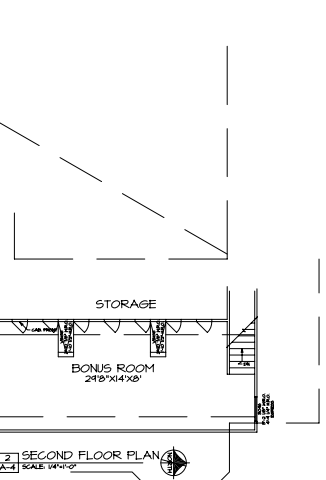

2 SECOND FLOOR PLAN  
A-4 SCALE: 1/4"=1'-0"

GALLIVAN'S  
DRAFTING & DESIGN  
(217) 202-5998

2539SF1SBONUSB.dwg